

# Knobs

## Specifications

<b>Door Preparation:</b>	Cross bore 2 1/8", edge bore 1", 1" x 2 1/4" latch mortise
<b>Backset:</b>	2 3/8" or 2 3/4"
<b>Door Thickness:</b>	1 3/8" to 1 3/4"
<b>Cylinder:</b>	KW1 standard, SC1 available, 5 pin
<b>Chassis:</b>	Cylindrical
<b>Faceplate:</b>	2 1/4" Round corner, drive-in available
<b>Strikes:</b>	2 1/4" Full rim standard for entry, 2 1/4" full lip standard for interior, others available
<b>Bolt:</b>	1/2" Throw
<b>UL:</b>	90 Minute fire rated available
<b>Door Swing:</b>	Entry & privacy functions for in-swinging doors only
<b>ANSI Grading:</b>	Meets Grade 2 standards

Finshes	Polished Brass (105)	Satin Nickel (119)	Polished Chrome (125)	Tuscan Bronze® (150)
Stafford	•	•		•
Ganyon	•	•	•	•
Lindingham		•		•
Webley	•	•		•
Barrett	•	•		

## Dimensions

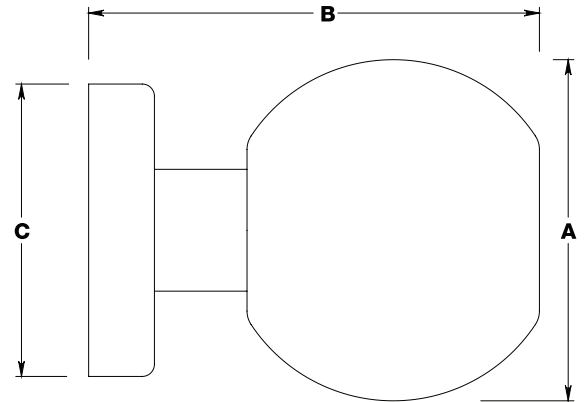

\*Dimensions shown are for outside knob, passage function, 1 3/8" thick door

Style	A(in)	B(in)	C(in)
Stafford	2.37	2.82	2.95
Ganyon	2.37	2.81	2.95
Lindingham	2.23	2.73	2.95
Webley	2.34	2.57	2.95
Barrett	2.12	2.81	2.95

## Functions

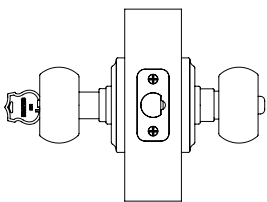

Keyed Entry

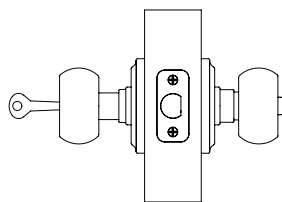

Privacy

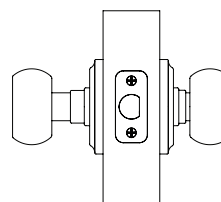

Passage

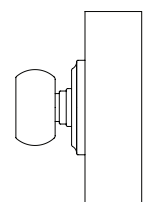

Dummy

## Finishes



Polished Chrome  
Ganyon



Satin Nickel  
Barrett



Tuscan Bronze®  
Stafford



Polished Brass  
Webley